

Photo Inventory



Setting

Outer Park Edges & Entry

The north side of the park is bordered by E. 6th. Native forest borders the remaining sides. Residential neighborhoods surround the park.

Active Recreation Areas

Active areas include:

Playground 5-12	
Tot Lot	
Pavement Games	
Play Field	

Passive Recreation Areas

**Benches
Picnic Tables
Picnic Shelter**

Playgrounds

Equipment List

No.	Item	Description	Issues/concerns
1	Big Toy Play Structure	ages 5-12, xx events, metal/wood multiple play events	Fair condition
2	2-play Swing	2 belts and 2 hot seats	Fair to good condition
3	Spring Fly	wood/metal	Good condition
4	Kompan Fire Truck	wood/metal	Good condition
5	Play House/Slide	plastic/metal	Fair to good condition
6	Safety Surface	pea gravel	Good condition

Accessibility Overview

Equipment does not meet 50%/% requirement for ADA. Needs accessible swinging element; play structure needs to be coordinated with manufacturer for ADA upgrades;

Pathways

Concrete sidewalks on north perimeter. Asphalt trail leads from E. 6th to playground. There are a number of dirt paths through the forest.

Green Space

Open lawn areas.

Location Map

Basics

5850 E. 6th Avenue
NE Park District
Northeast Community Council
Legis. Dist. 19J Assem. Dist. 5
7.4 acres

In 1981, community requested that this property be placed on the Capital improvement list and purchased as park land. 2008 grade F

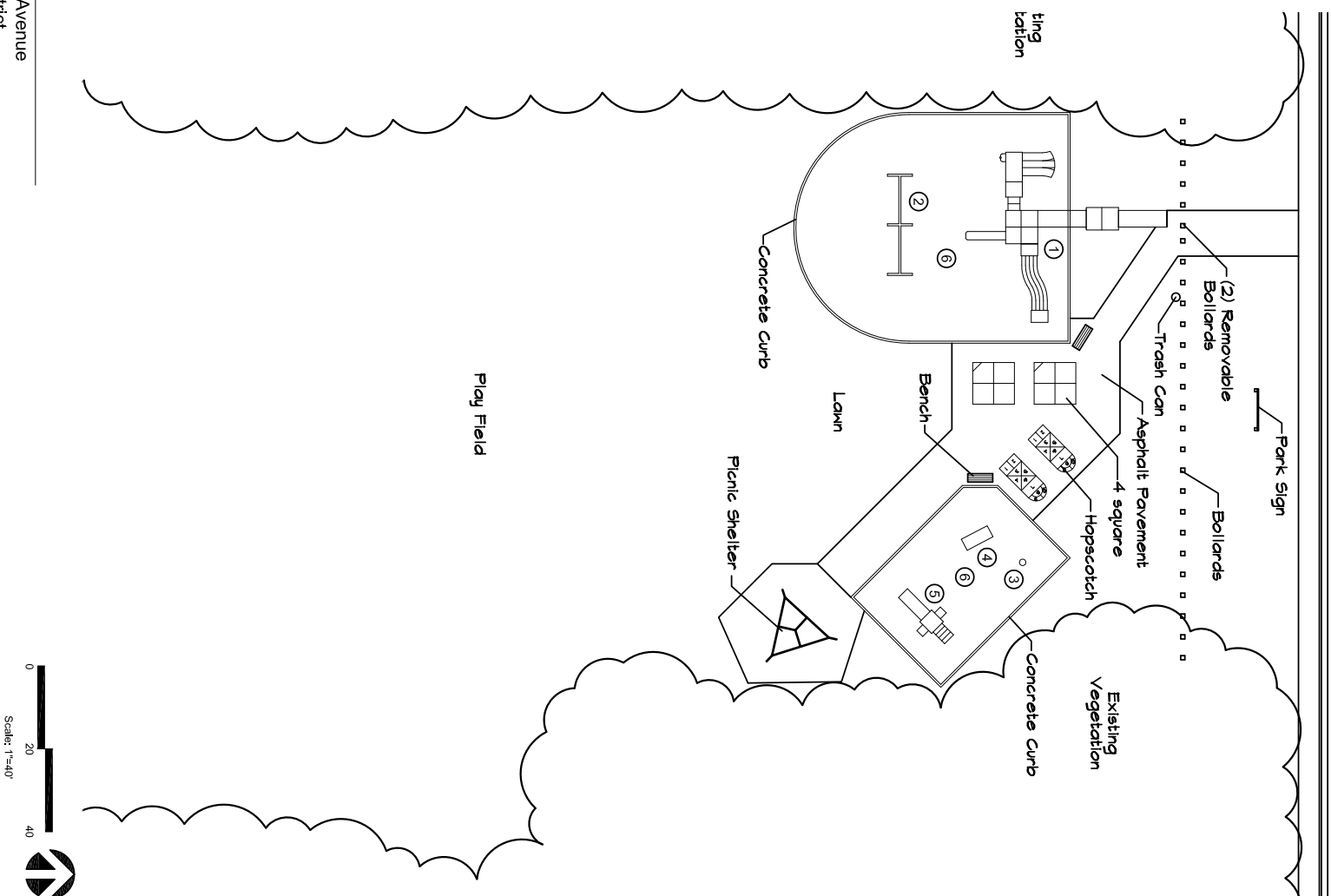
[illegible]