

AIRPORT HEIGHTS COMMUNITY COUNCIL
Resolution 2015-05

A RESOLUTION OF AIRPORT HEIGHTS COMMUNITY COUNCIL (AHCC)
REGARDING REZONING FOR ALL AIRPORT HEIGHTS PARKLAND

WHEREAS, the *2006 Anchorage Bowl Park, Natural Resource, and Recreation Facility Plan* (page 4), states “Anchorage’s parks, natural open space, greenbelts, trails, viewsheds, and access to thousands of acres of wilderness give special character to the city and all-season access to adventures and nature. In return, parks add charm to neighborhoods, increases property values, and provide a balance between nature and urban development,”

WHEREAS, the *2001 Anchorage Bowl 2020 Comprehensive Plan, Parks, Trails, Recreation Policy #85* (page 89) states “Municipal land acquired for or converted to long-term or permanent park or recreational uses shall be officially dedicated as parkland,”

WHEREAS, *Anchorage Municipal Code (AMC) 25.10.080.B – Use of municipal property for park and recreational purpose* states “The assembly, by ordinance may dedicate specifically described property for permanent or long-term park or recreational purposes under the meaning of Charter section 10.02(8). Following October 16, 1979, no lands may be formally dedicated to permanent or long-term park or recreational use except as provided by ordinance,”

WHEREAS, *AMC 21.04.060.F.1: PR: Parks and Recreation District Purpose* states “The PR district is intended to include municipal lands dedicated by the assembly as parks in accordance with AMC 25.10.080,”

WHEREAS, Airport Heights residents, neighboring physical and mental healthcare facilities, universities, K-12 schools along with the Anchorage community at large and visitors to our city have for many years enjoyed the parkland, trails, greenbelt, and wooded areas within the AHCC boundaries, and value the quality-of-life benefits these areas provide our neighborhood and formal parkland dedication of these lands provides a much higher assurance of protection, as *AMC 25.30.020 – Disposal by ordinance* states “An ordinance disposing of municipal land formally dedicated to permanent or long-term park or recreational purposes is valid only upon approval by a majority of those voting on the questions at a regular or special election,”

NOW THEREFORE BE IT RESOLVED, that the Airport Heights Community Council requests support from the Parks and Recreation Commission, and action by the Anchorage Assembly, to dedicate as parkland, and rezone as PR, all currently owned Municipal designated parkland within the AHCC boundaries (including those specifically identified on Attachment A) as well as any property transferred to the Municipality in the future within the AHCC boundaries that is intended for use as parkland.

THIS RESOLUTION WAS APPROVED by the Airport Heights Community Council on May 21, 2015 by a vote of: FOR 19, AGAINST 0, ABSTAIN 1.

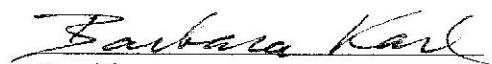

President

Map ID#	Park Name	Parcel ID #	Address	Dedicated	Zone	Acres
1A	Nichols	004-125-10-000	Grandview Gardens BLK 6B LT 4	1967	R2D	0.53
1B	Nichols	004-125-11-000	Grandview Gardens BLK 7 LT 9	1967	R2D	0.36
1C	Nichols	004-125-12-000	Grandview Gardens BLK 6B LT 2	1967	R2D	0.21
1D	Nichols	004-125-13-000	Grandview Gardens BLK 6B LT 1	1967	R2D	0.13
2A	Tikishla Park, North	004-141-20-000	North Tikishla Park Tract A	AO 84-199	PLI	6.67
2B	Tikishla Park	004-151-01-000	T13N R3W SEC 21 Lake Otis & Tikishla Park	AO 84-199	PLI	50.87
2C	Tikishla Park	004-161-04-000	T13N R3W SEC 21 LT 6A	AO 84-199	PLI	38.95
2D	Tikishla Park	004-162-42-000	Anchor Park BLK 10 LT 3A	AO 84-199	R1	1.7
2E	Tikishla Park	004-162-43-000	Anchor Park BLK 10 LT 1A	AO 2005-55	R2SL	2
2F	Lake Otis/Tikishla Park	004-171-27-000	Goose Lake LT 4A	96-R-66	PLI	0.52
2G	Tikishla Park	004-154-26-000	Anchor Park BLK 7 LT 33D	AO 84-199	R1	0.19
2H	Tikishla Park	004-154-27-000	Anchor Park BLK 7 LT 33E	AO 84-199	R1	0.19
2I	Tikishla Park	004-154-28-000	Anchor Park BLK 7 LT 33F	AO 84-199	R1	0.24
2J	Tikishla Park	004-154-29-000	Anchor Park BLK 7 LT 33C	AO 84-199	R1	0.17
2K	Tikishla Park	004-154-30-000	Anchor Park BLK 7 LT 33B	AO 84-199	R1	0.17
2L	Tikishla Park	004-154-31-000	Anchor Park BLK 7 LT 33A	AO 84-199	R1	0.17

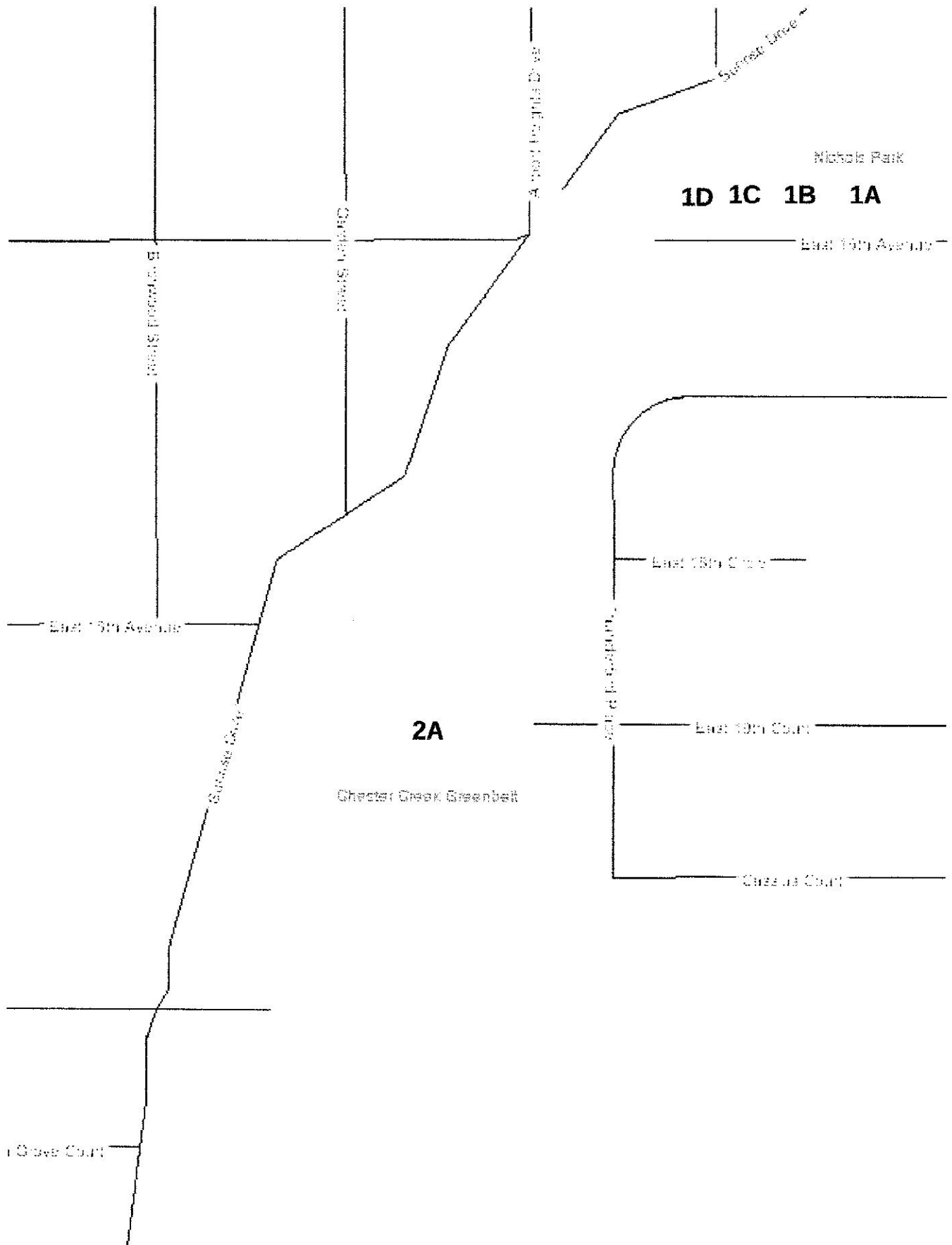
Map A Airport Heights Community Council Resolution Regarding Rezoning for all Airport Heights Parkland

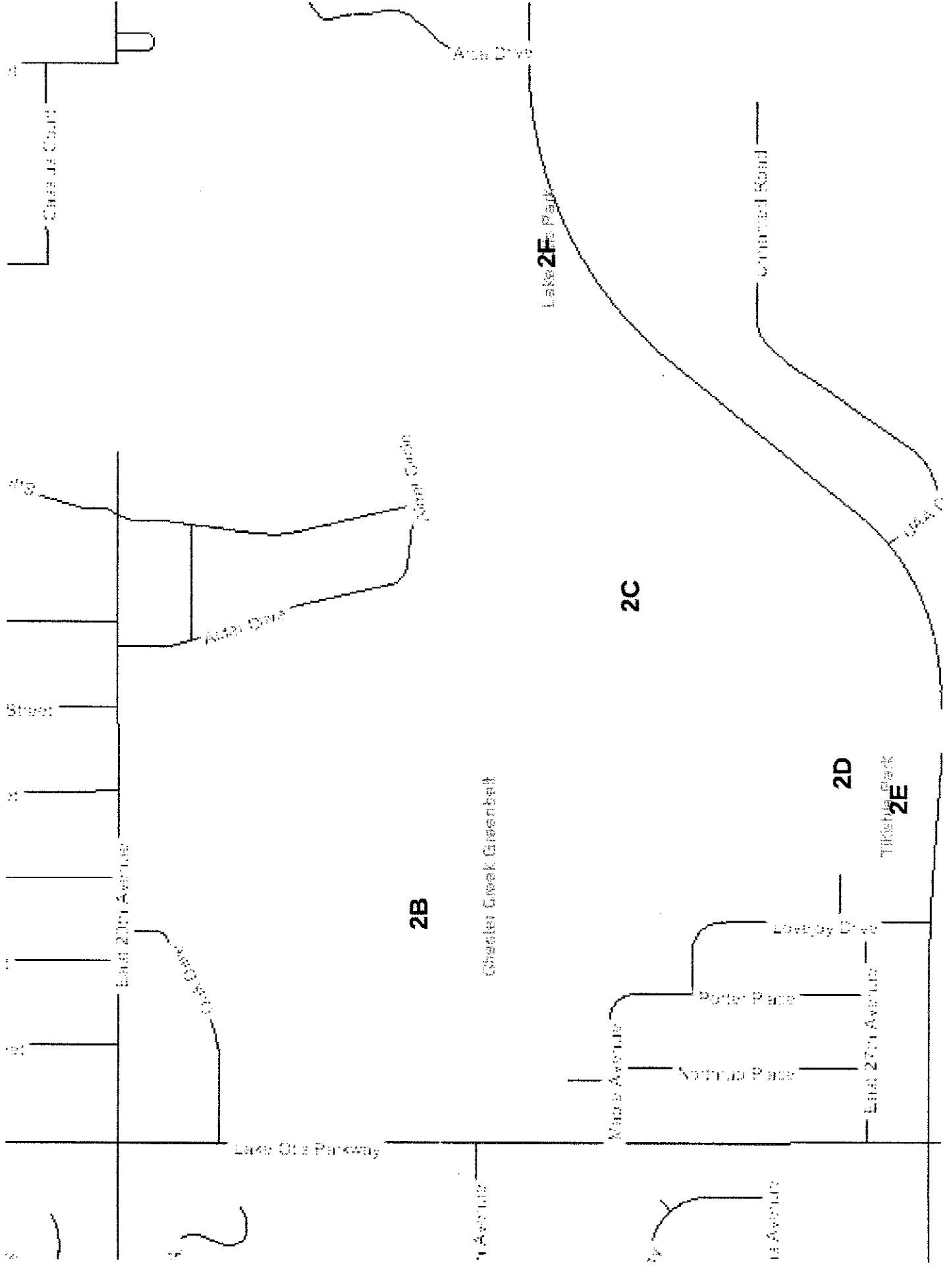

Map B Airport Heights Community Council Resolution Regarding Rezoning for all Airport Heights Parkland



**Map C Airport Heights Community Council Resolution Regarding Rezoning
for all Airport Heights Parkland**

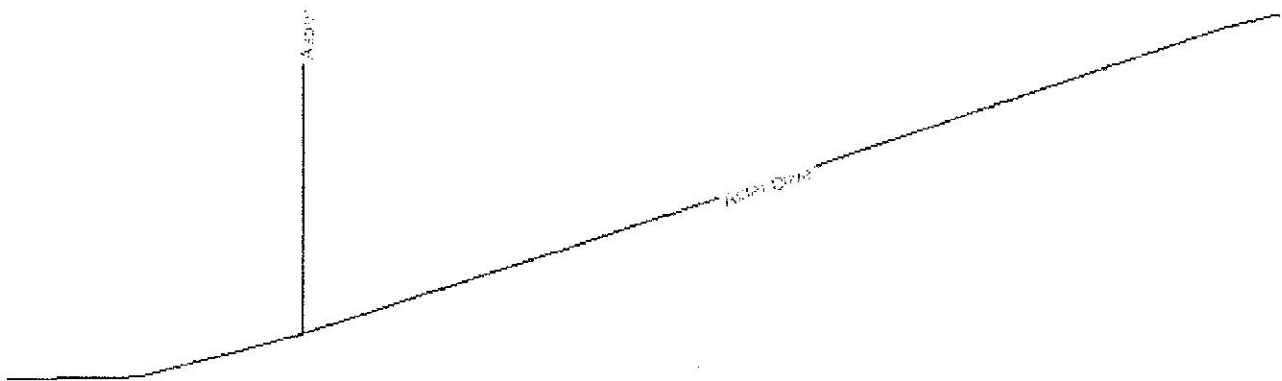

2I

2H

2G

2J

2K

2L

reznick