

Correspondence



RABBIT CREEK COMMUNITY COUNCIL (RCCC)

A Forum for Respectful Communication & Community Relations

1057 West Fireweed Lane, Suite 100 / Anchorage, AK 99503

Assembly, Municipality of Anchorage
PO Box 196650
Anchorage, AK 99519

June 20, 2022

RE: 2022-0074 Proposed Alcohol package store location — 1160 Huffman Park Dr, 99515

Dear Assembly Members:

The Rabbit Creek Community Council (RCCC) discussed Brown Jug's request to transfer an alcohol permit to Huffman Park at our June 9, 2022, monthly meeting. We reviewed the Old Seward/Oceanview Community Council's (OSOVCC) Resolution #2022-01 opposing this transfer. We agreed with their resolution and RCCC voted 20 yeas, zero nays, and 3 abstentions to recommend denial of this transfer.

While the RCCC was not notified of this request, the Huffman Business Park is our closest shopping area. Our Bylaws state that, as part of our Purpose, we are to review liquor license notices.

The RCCC asks that the Assembly consider two key factors before voting on this permit transfer – the existing density of package stores in this area, and the relationship of density to alcohol consumption and related issues:

- The accompanying map shows the high density of stores selling alcohol near the proposed Brown Jug location – some being only a few hundred feet away. Four alcohol stores are in very close proximity, while another is less than a mile away. Numerous restaurants in the area also serve alcohol.
- Please know that liquor stores are not permitted south of Huffman Road per Warranty Deed February 25, 1961.
- Anchorage, and many cities across the United States, require a process that includes community input before approving of package store locations. If done well, this can be a public health tool for reducing alcohol-related issues.
- The RCCC would like to draw your attention to studies on the density of package stores to alcohol consumption and related harms (<https://pubmed.ncbi.nlm.nih.gov/19944925/>). The studies show that with more permissive licensing procedures and a higher density of on and off-premises alcohol outlets, there is an increase in alcohol consumption.*

- With greater alcohol consumption, the studies indicate there is increased injury (needing medical attention), crime, auto accidents, and interpersonal violence.

Apparently, the Brown Jug owners have been in negotiations to locate their store at this location for some time, but there appears to have been little effort to work with the main council (OSOVCC) and other neighborhoods for whom Huffman is their closest shopping area before firming up details. While this is unfortunate, it should not override the fact that the area already has a high density of alcohol outlets. With that density comes higher alcohol consumption and related health and community issues per scientific studies. We would appreciate your attention to our Community Councils concerns and your denial of this request.

Sincerely,

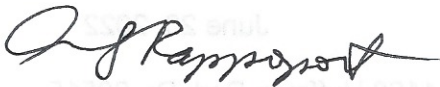

Ann Rappoport, Co-chair

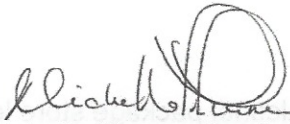

Michelle Turner, Co-chair

*<https://pubmed.ncbi.nlm.nih.gov/19944925/> Carla Alexia Campbell¹, Robert A Hahn, Randy Elder, Robert Brewer, Sajal Chattopadhyay, Jonathan Fielding, Timothy S Naimi, Traci Toomey, Briana Lawrence, Jennifer Cook Middleton, Task Force on Community Preventive Services 2009. The effectiveness of limiting alcohol outlet density as a means of reducing excessive alcohol consumption and alcohol-related harms. American Journal of Preventive Medicine. Dec:37(6):556-69

Attachment

cc: MOA Assembly
Old Seward/Oceanview Community Council

Attachment

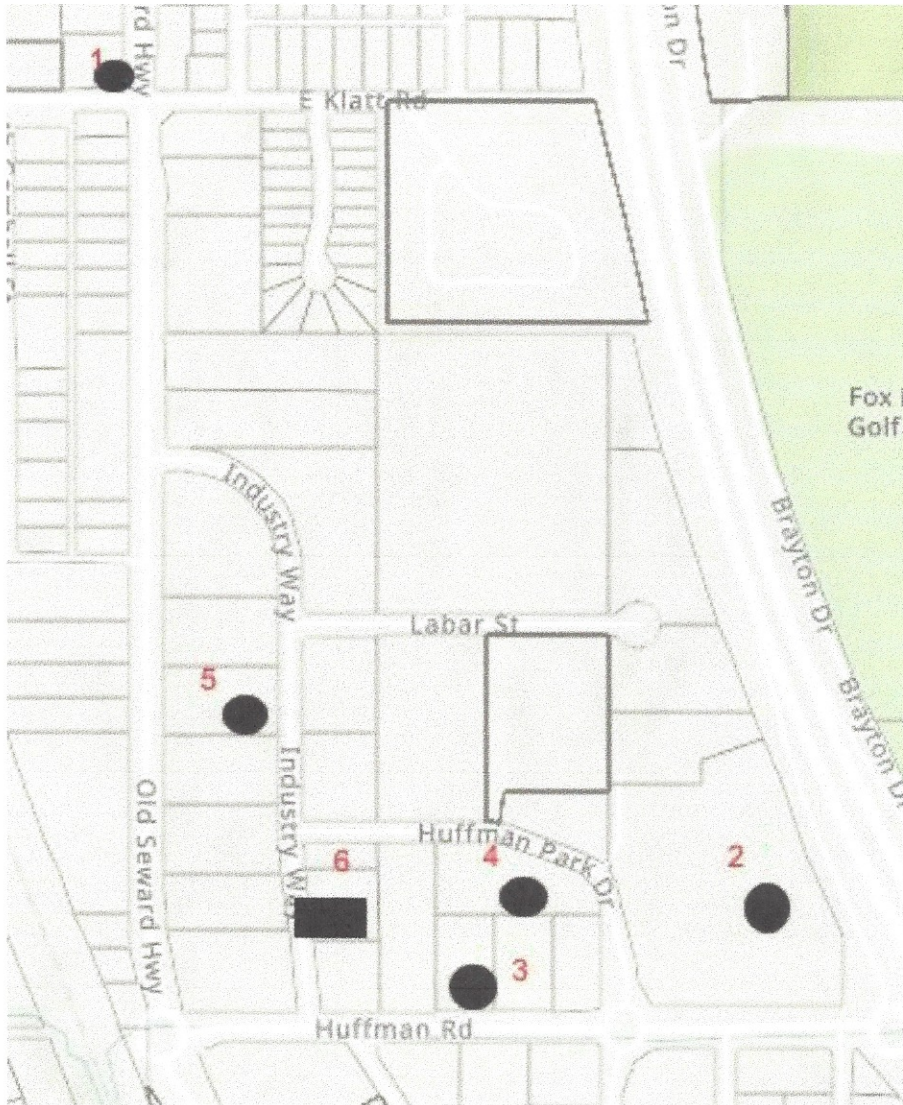

Locations of existing liquor stores in/near Huffman Business Park:

1. Value Liquor
2. Oaken Keg
3. Speedway Express
4. Wine House
5. Raven's Ring
6. Proposed Brown Jug