

Drawing J:\BIG-21-03 Northernlights-Minnesota2 - CAD\NL-Minn - Corvus-Sheets.dwg last saved on 4/30/2021 8:36 AM was plotted by Bradley Little on 4/30/2021 10:22 AM

SEAL:

VITUS  
**NORTHERN LIGHTS & MINN.**  
 DRAFT PERMIT  
 ANCHORAGE, AK

If the above dimension does not measure exactly 1", this drawing has been enlarged or reduced, affecting all scales.

DATE: 04/30/2021  
 JOB NUMBER: BIG-21-03  
 DRAWN BY: BL  
 CHECKED BY: PB

PLANTING PLAN  
 SHEET #:  
**L102**

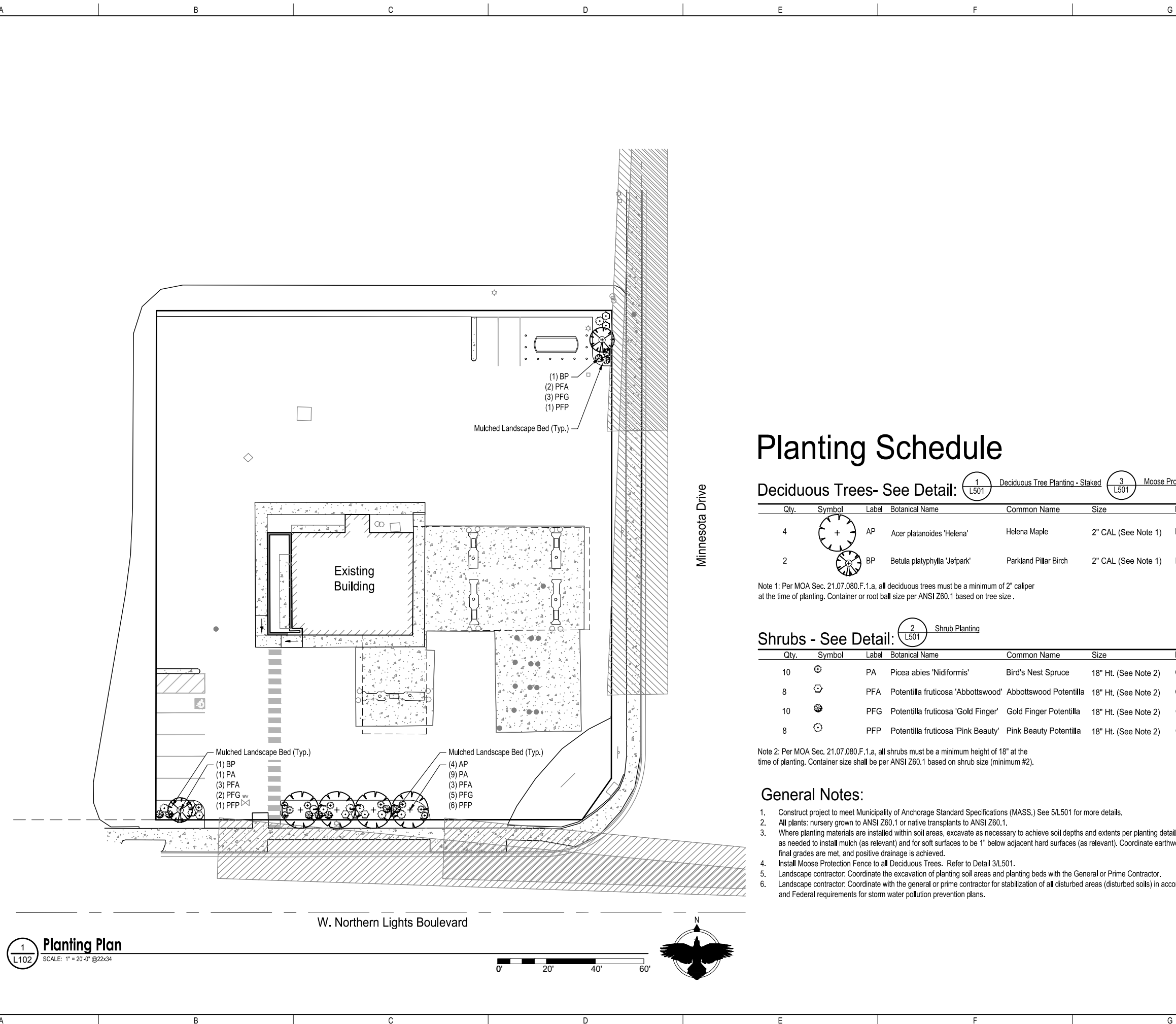

## Planting Schedule

Deciduous Trees- See Detail: 1 L501 Deciduous Tree Planting - Staked 3 L501 Moose Protection

Qty.	Symbol	Label	Botanical Name	Common Name	Size	Furnished	Notes
4		AP	Acer platanoides 'Helena'	Helena Maple	2" CAL (See Note 1)	B&B	Single stem
2		BP	Betula platyphylla 'Jefpark'	Parkland Pillar Birch	2" CAL (See Note 1)	B&B	Single stem

Note 1: Per MOA Sec. 21.07.080.F.1.a, all deciduous trees must be a minimum of 2" caliper at the time of planting. Container or root ball size per ANSI Z60.1 based on tree size.

Shrubs - See Detail: 2 L501 Shrub Planting

Qty.	Symbol	Label	Botanical Name	Common Name	Size	Furnished	Notes
10		PA	Picea abies 'Nidiformis'	Bird's Nest Spruce	18" Ht. (See Note 2)	CG	
8		PFA	Potentilla fruticosa 'Abbottswood'	Abbottswood Potentilla	18" Ht. (See Note 2)	CG	
10		PFG	Potentilla fruticosa 'Gold Finger'	Gold Finger Potentilla	18" Ht. (See Note 2)	CG	
8		PFP	Potentilla fruticosa 'Pink Beauty'	Pink Beauty Potentilla	18" Ht. (See Note 2)	CG	

Note 2: Per MOA Sec. 21.07.080.F.1.a, all shrubs must be a minimum height of 18" at the time of planting. Container size shall be per ANSI Z60.1 based on shrub size (minimum #2).

### General Notes:

- Construct project to meet Municipality of Anchorage Standard Specifications (MASS.) See 5/L501 for more details.
- All plants: nursery grown to ANSI Z60.1 or native transplants to ANSI Z60.1.
- Where planting materials are installed within soil areas, excavate as necessary to achieve soil depths and extents per planting details plus additional excavation as needed to install mulch (as relevant) and for soft surfaces to be 1" below adjacent hard surfaces (as relevant). Coordinate earthwork activities to ensure that final grades are met, and positive drainage is achieved.
- Install Moose Protection Fence to all Deciduous Trees. Refer to Detail 3/L501.
- Landscape contractor. Coordinate the excavation of planting soil areas and planting beds with the General or Prime Contractor.
- Landscape contractor. Coordinate with the general or prime contractor for stabilization of all disturbed areas (disturbed soils) in accordance with Local, State, and Federal requirements for storm water pollution prevention plans.

1 L102  
**Planting Plan**  
 SCALE: 1" = 20'-0" @ 22x34

