



Alaska Alcoholic Beverage Control Board Form AB-02: Premises Diagram

What is this form?

A detailed diagram of the proposed licensed premises is required for all liquor license applications, per AS 04.11.260 and 3 AAC 304.185. Your diagram must include dimensions and must show all entrances and boundaries of the premises, walls, bars, fixtures, and areas of storage, service, consumption, and manufacturing. If your proposed premises is located within a building or building complex that contains multiple businesses and/or tenants, please provide an additional page that clearly shows the location of your proposed premises within the building or building complex, along with the addresses and/or suite numbers of the other businesses and/or tenants within the building or building complex.

The second page of this form is not required. Blueprints, CAD drawings, or other clearly drawn and marked diagrams may be submitted in lieu of the second page of this form. The first page must still be completed, attached to, and submitted with any supplemental diagrams. An AMCO employee may require you to complete the second page of this form if additional documentation for your premises diagram is needed.

This form must be completed and submitted to AMCO's main office before any license application will be considered complete.

Yes No

I have attached blueprints, CAD drawings, or other supporting documents in addition to, or in lieu of, the second page of this form.

Section 1 – Establishment Information

Enter information for the business seeking to be licensed, as identified on the license application.

Licensee:	Alaska Premier Auctions and Appraisals, LLC	License Number:	
License Type:	Package Store		
Doing Business As:	Alaska Premier Liquor		
Premises Address:	1310 West International Airport Road		
City:	Anchorage	State:	AK
		ZIP:	99518

International Airport Rd.

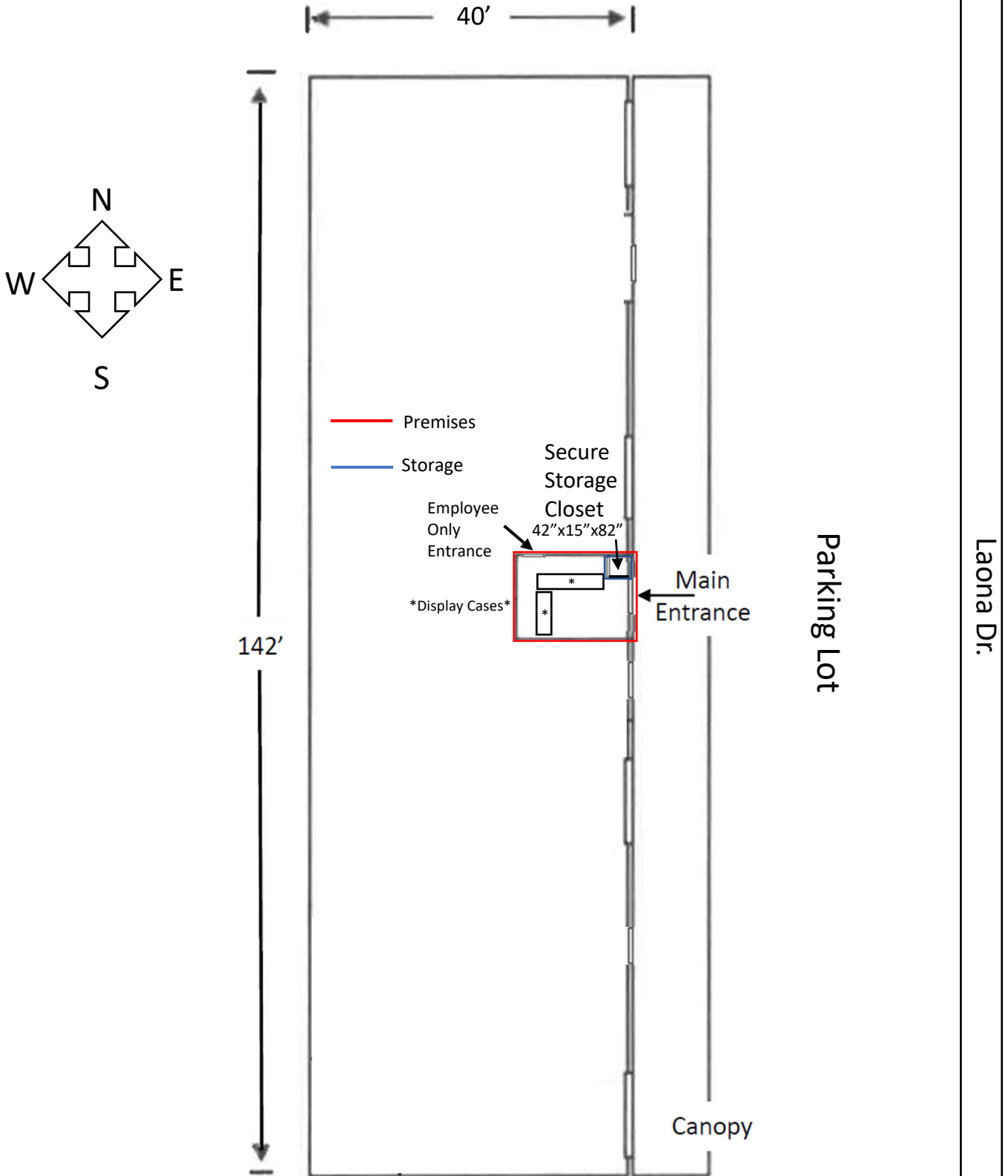

1310 West International Airport Road, Anchorage, AK 99518

AMCO RECV 3/19/21

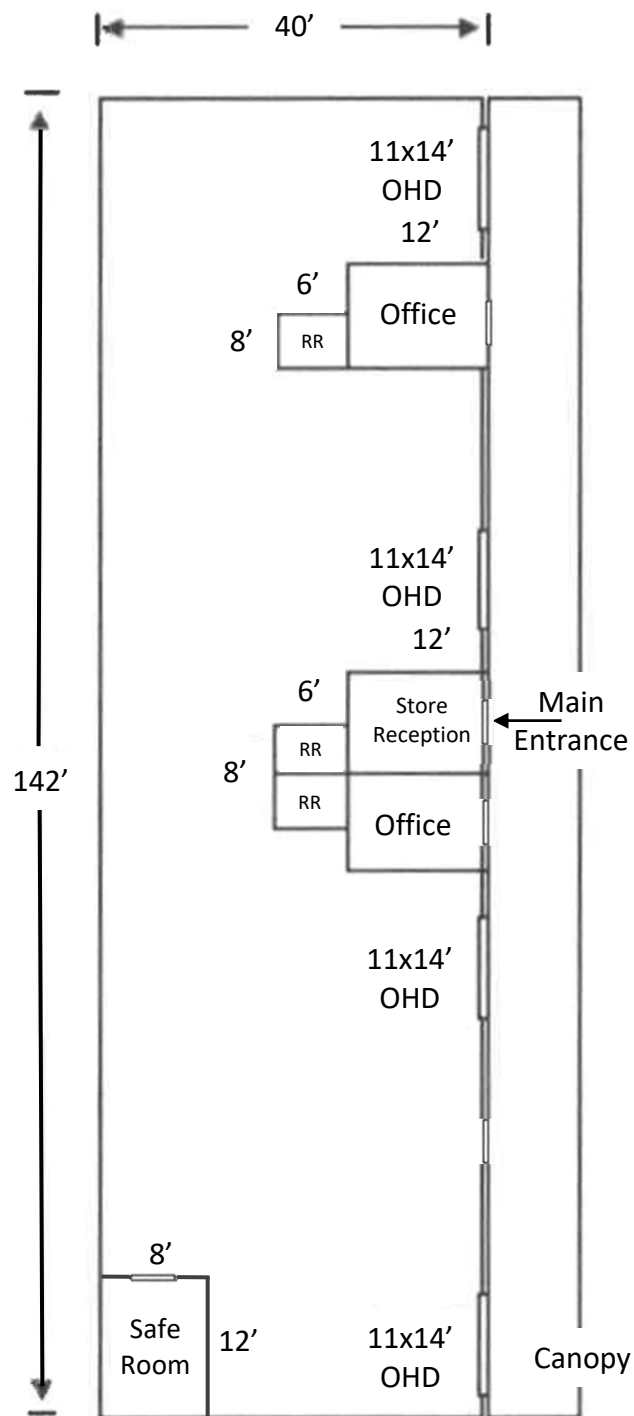

Building 1310