

Community Concerns - Proposed Bernard Drive R.O.W. Vacation

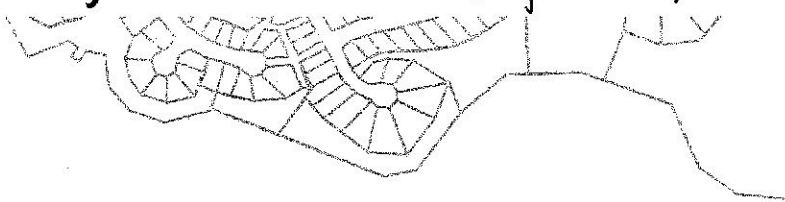

Property Information Eagle River, Alaska

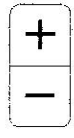

Bernard Drive Proposed ROW Vacat

author

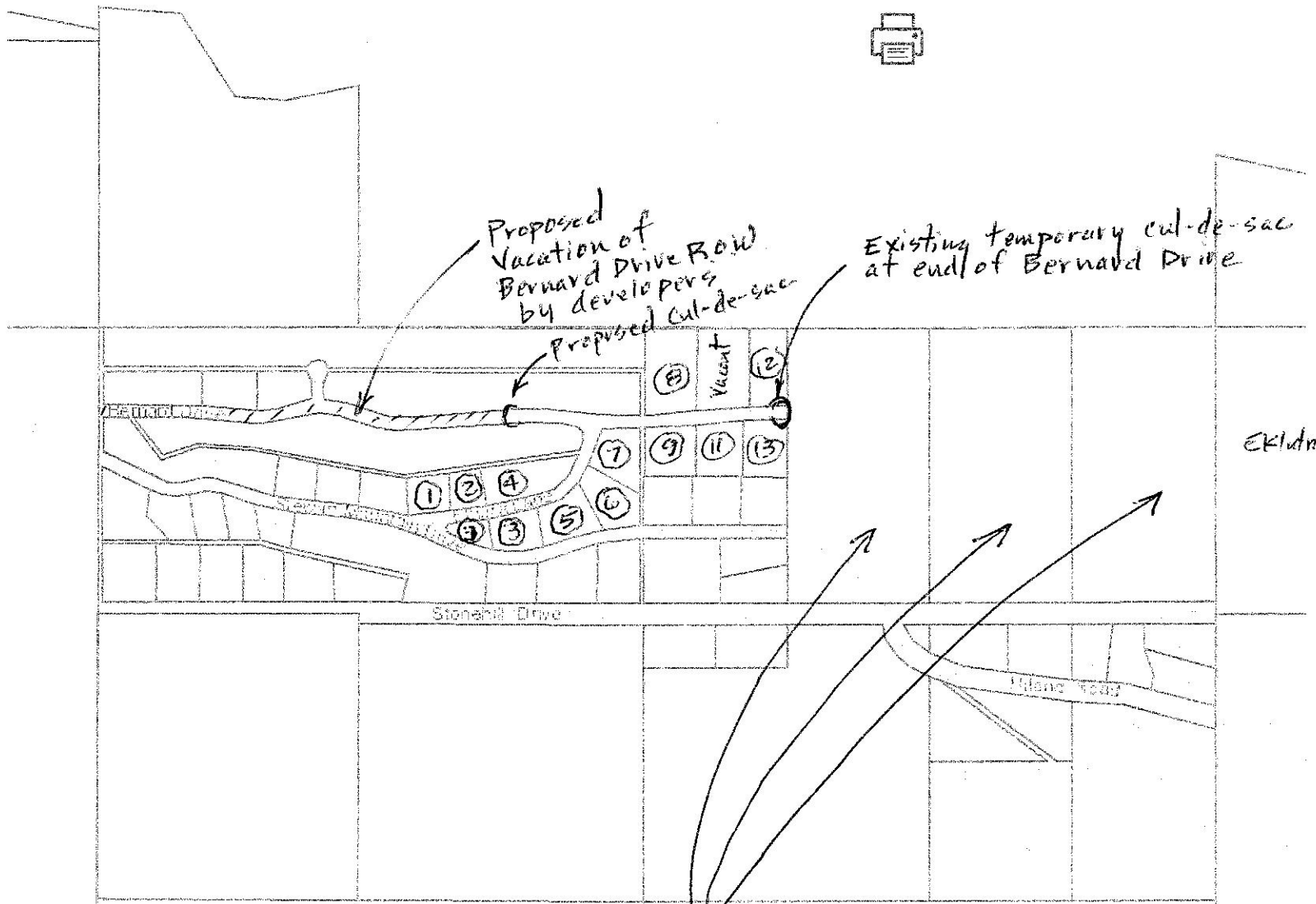

Eklutna

Key

Ⓢ Homeowners on Elnora Lane and Bernard Drive unanimously object to proposed vacation of Bernard drive R.O.W. for safety reasons and egress issues. See petition (attached) that state concerns as signed by all homeowners on Elnora Lane and Bernard Drive.

3) 20 Acre Parcels (60 Acres total) that will potentially use Bernard Drive for access in the future. (Also Eklutna lands to the east of this 60 Acres.)

Municipality of Anchorage, Esri, HERE

Note that access to the three 20 Acre parcels off the east end of Bernard drive is practical given the topography. Access to these parcels from Stewart Mtn. Drive and Stonehill Drive is impracticable because of steep terrain.